

ENROLL IN DUO

[HOME](#) / [DEPARTMENTS](#) / [DIVISION OF INFORMATION TECHNOLOGY](#) / [TECHNOLOGY TUTORIALS](#) / [DUO](#)

Enroll Language
Powered by Duo Security

We're committed to safeguarding your accounts and data through multi-factor authentication (MFA). This extra layer of protection ensures that only authorized users gain access to your sensitive information. Let's walk you through the simple steps of enrolling in Duo for the first time.

What is Multi-Factor Authentication (MFA)?

Multi-Factor Authentication adds an extra layer of security beyond your password. Instead of relying solely on something you know (like a password), MFA requires at least two forms of identification, such as something you know, something you have, or something you are. Duo incorporates this approach to enhance the security of your accounts.

On this page

- ↓ [How it Works](#)
- ↓ [Enroll](#)
- ↓ [Add or Manage Devices After Enrollment](#)

How it Works



Technology Tutorials

[Home](#)

[Service Desk](#)

[Technology Tutorials](#)

[Contact Us](#)

Contact Us

Location: [AB1](#) Room 145

Phone: [\(936\) 294-1950](#)

Email: servicedesk@shsu.edu

Live Support: support.shsu.edu

Follow IT:

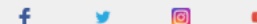

Enroll

Step One: Download Duo Mobile App

Download and install Duo Mobile on your phone or tablet from the ► [Google Play Store](#) or 🍏 [Apple App Store](#). You will be prompted to do this in the setup process but we find it easier to do this first!

Duo Mobile runs on iOS and Android phones and tablets. It is fast and easy to use, and doesn't require cell services. Duo pushes login requests to Duo Mobile when you have mobile data or wifi connectivity to the internet. When you have no data service, you can generate passcodes with Duo Mobile for logging in to applications.

Step Two: Login

On a computer or separate mobile device, **login to duo.shsu.edu** with your SHSU username and password.

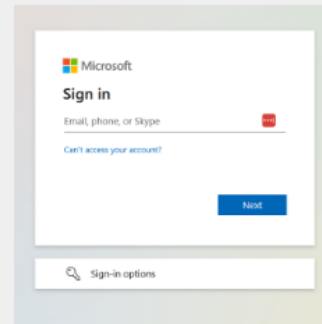

Step Three: Navigate Onboarding

Select **Next** to learn why protecting your identity with two-step verification is important and begin the setup process.

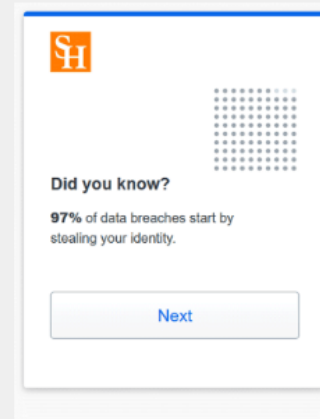

Step Four: Choose Your Verification Method

Select **Duo Mobile** to approve Duo Push verification requests on iOS or Android devices, or generate a one-time passcode from the Duo Mobile app.

You can [contact our IT Service Desk](#) to [purchase](#) and add use a security key. A security key is an external device that when tapped or when the button is pressed sends a signed response back to Duo to validate your login. [Learn more about security keys.](#)

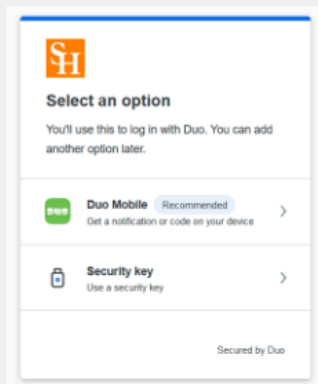

Step Five: Enter your phone number

Enter and confirm your phone number or select **I have a tablet** instead.

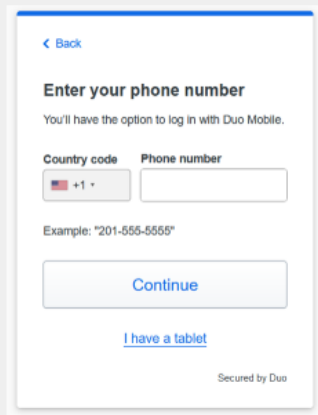

Step Six: Verify Duo Mobile App Install

Once you have Duo Mobile installed select **Next**.

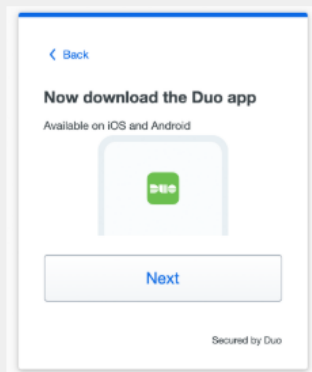

Step Seven: Scan QR Code

Open the Duo Mobile app on your phone or tablet and add this account by scanning the QR code shown on-screen. When you receive confirmation that Duo Mobile was added select **Continue**.

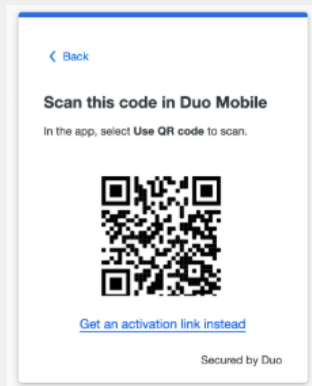

ⓘ If you aren't able to scan the QR code, select **Get an activation link** instead and then enter your email address to send the activation link to yourself. Follow the instructions in the email to activate the new account in Duo Mobile.

Add or Manage Devices After Enrollment

Login to your device management portal at duo.shsu.edu and use Duo tutorials below to add, rename, remove, or reactivate a device.

- [Add Another Device](#)
- [Rename or Remove Device](#)
- [Reactivate Duo Mobile for an Existing Device](#)



Huntsville, Texas 77341
936.294.1111 | (866) BEARKAT

Contacts

University Contacts
Personnel & Department Search
Contact the Web Editor
Office of the President
Administration
Faculty & Staff
State of Texas
Employment
Mental Health Counseling

More SHSU

Accreditations
Policies
Web Privacy and Site Link Statement
Web Site Accessibility
Open Records
KatSafe - Emergency Management
Texas Homeland Security
Texas Veterans Portal
TRAIL

Fraud Reporting Hotline
Title IX (Sexual Misconduct)
Annual Security & Fire Report (Clery Act)
State Auditor's Office Hotline
Online Institutional Resumes
Governor's Committee on People with Disabilities
Where the Money Goes
Texas CREWS
Public Access to Course Information
CARES